

MATERIAL SPECIFICATIONS
 ALL PANELS: 0.9mm 430 GRADE ST.STL.
 WALL BRACKETS: 1.5mm 430 GRADE ST.STL.

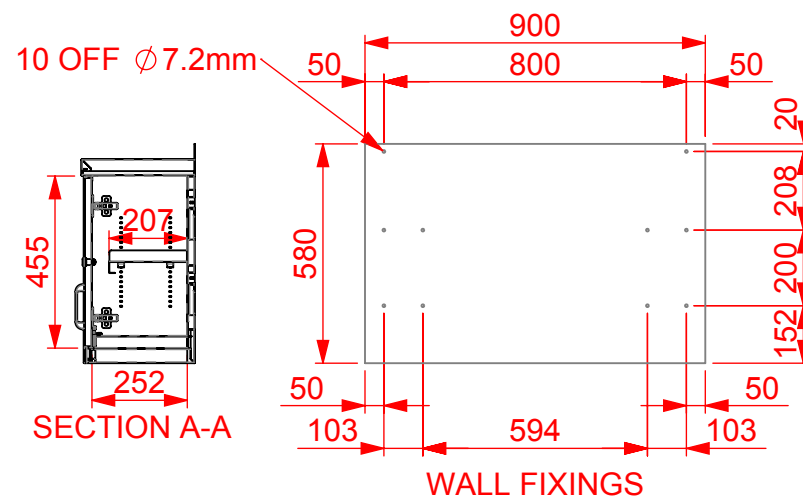

APPROVAL FOR
MANUFACTURE

Signature..... Print.....

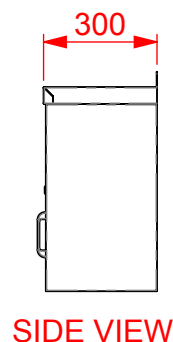
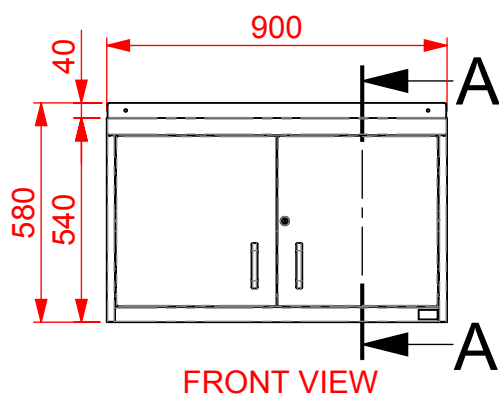
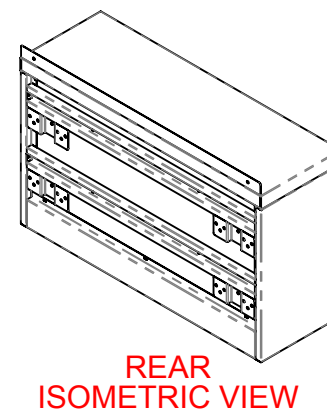
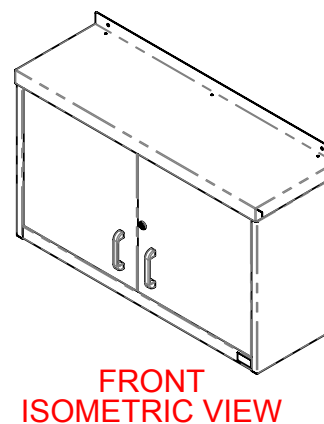
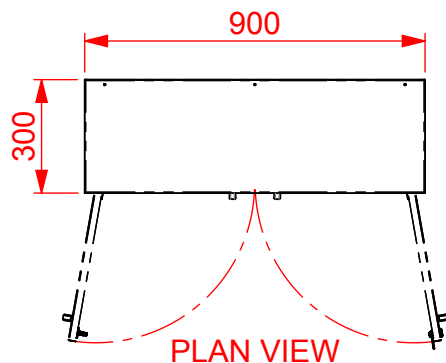

CED FABRICATIONS LTD
 CLAYTON HOUSE
 CLAYTON BUSINESS PARK
 CLAYTON-LE-MOORS
 HYNDBURN
 LANCASHIRE BB5 5JD

This drawing and information herein is confidential to CED Fabrications Ltd. It is issued in confidence that it will not be disclosed to any third party in part or in whole without permission from CED FABRICATIONS Ltd.

© 2005 CED FABRICATIONS LTD

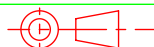

DO NOT SCALE

CUSTOMER Ref:

TITLE: W.CUPBD-LCK.DOORS-540(H)x900(L)x300(D)

DRAWN BY: AHR CUSTOMER O/No:

DATE: 21/02/2019

SCALE: 1:20

A

NEW DESIGN

21/02/2019

REV.

REVISION

DATE

REV No: A

DRG No: QWC93LH